

Evolve 2005 Setup

| | | |
|------------------|---------------------|-----------|
| Fastest Lap 1 | FastQ Scott 17/5.03 | Who Scott |
| Our Fastest 17.0 | Our Fastest 17.0 | |

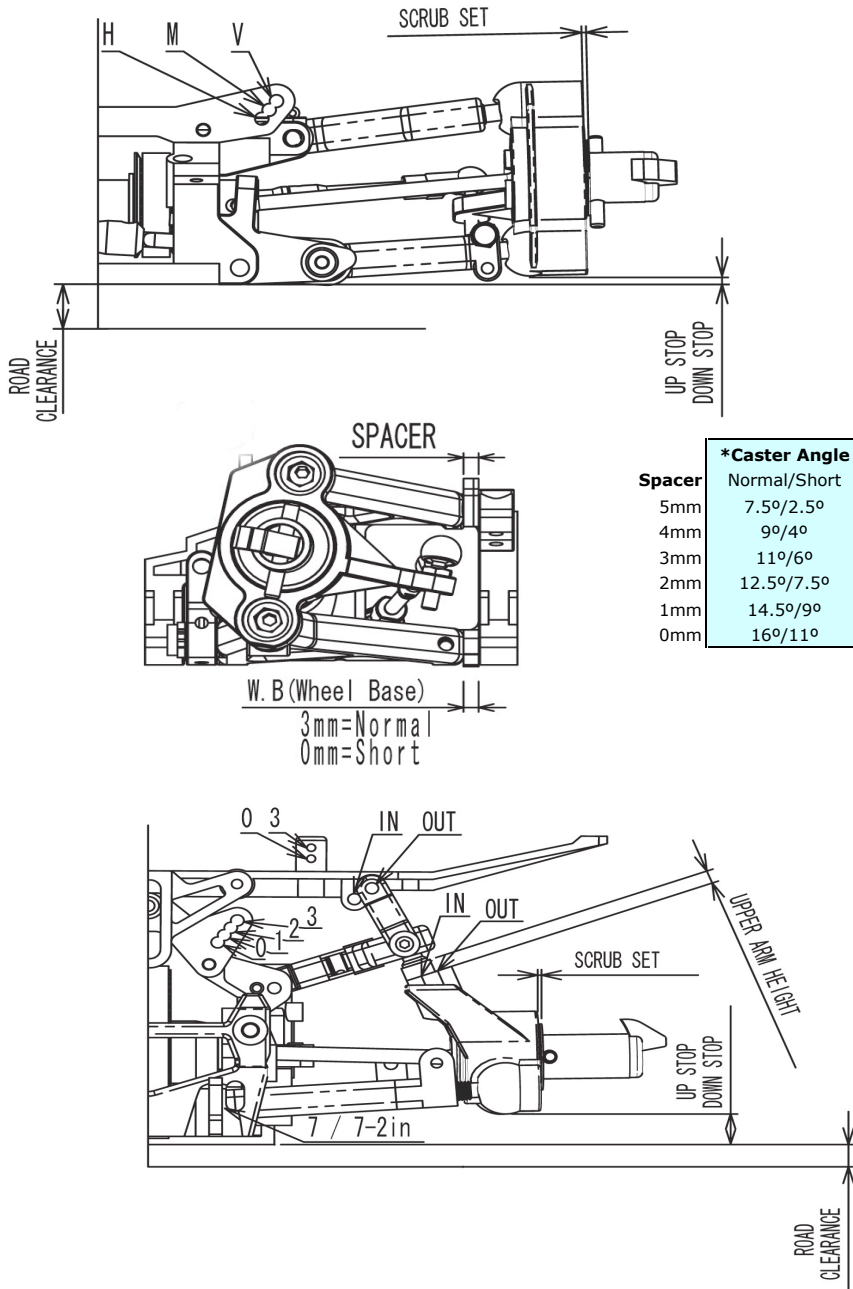

| Gear | Ratio |
|-------|--------|
| 15 48 | 7.68:1 |
| 16 48 | 7.20:1 |
| 17 48 | 6.78:1 |
| 15 49 | 7.84:1 |
| 16 49 | 7.35:1 |
| 17 49 | 6.92:1 |
| 19 44 | 5.56:1 |
| 20 44 | 5.28:1 |
| 21 44 | 5.03:1 |
| 19 45 | 5.68:1 |
| 20 45 | 5.40:1 |
| 21 45 | 5.14:1 |

| | |
|--------------------------|----------------------------|
| Name | Scott Kimbrow |
| Date | 8/2/06 |
| Track | Ohio |
| Temp | 100 |
| Humidity | 90% |
| Air Density | 93% lowest |
| Traction | Sugar,Castor, Meth |
| Engine | 326 |
| Head Clearance | .025" |
| Restrictor | 9mm |
| Plug No. | 7COLD |
| Servo Saver | 10 |
| Servo Save Position (mm) | 0 |
| Steering Angle(%) | 100% |
| Front Upper O/2 | 4mm/05 Empire |
| Knuckle Arm Spacer | Silver |
| •Front• Shock Oil | 500 |
| Diaphragm | MUGEN |
| Shock Piston | 1 HOLE - 1.2mm |
| Spring | WHITE |
| Spring Adjuster | |
| Shock Pos. | v |
| Scrub Set | .5mm/bearing insert |
| Caster°* /W.B. | 11°/long |
| Camber° /L | 1.25 |
| Camber° /R | 1.25 |
| Toe ° | 0.75 |
| Front Width | 252 |
| Up Travel | 4.0mm |
| Down Stop | N/A |
| AntiRoll Bar | Cut, flat ° |
| Tire Hardness | 37 |
| Tire Type | Kyosho |
| Tire Diameter | 65.5 |
| Road Clearance | 7 |
| •Rear• Shock Oil | 500 |
| Diaphragm | MUGEN |
| Shock Piston | 2 HOLE 1.2mm |
| Spring | Kyosho Black |
| Spring Adjuster | |
| Shock Pos. | 0 |
| Scrub Set | 1 |
| Upper Arm(mm) | 5 |
| Camber° /L | 2.5 |
| Camber° /R | 2 |
| Toe ° | 4° |
| Rear Width | 258 |
| Up Stop | 10mm |
| Down Stop | N/A |
| AntiRoll Bar | EMPIRE 3 mm |
| Tire Hardness | 37 |
| Tire Type | Kyosho |
| Tire Diameter | 72.5 |
| Road Clearance | 7 mm |
| SUS Holder | Empire 8-2, Black |
| Body | Dome |
| Body Position | 3mm |
| Rear Spoiler | -.3 mm |
| Clutch Type | 3D |
| Clutch Shoe | Grey |
| Centrifugal Shoe | N |
| Clutch Spring | JP |
| Clearance | .25mm |
| Adj. Nut | 1.50mm |
| Body Mount Position | in |
| Body Mount Height | 0 |
| Overdrive Percentage | 0.074% |
| Low Gear | High Gear |
| Pinion Gear | 15 |
| Spur Gear | 48 |
| Drive Ratio | 7.68 |
| Rollout | 29.66 |
| | 20 |
| | 44 |
| | 5.28 |
| | 43.14 |